

Introduction...

The types of expansion joints used in Fluid Catalytic Cracking Unit (FCCU) service are some of the most critical expansion joints manufactured. Operating at high pressures, temperatures, large movement conditions and very aggressive media.

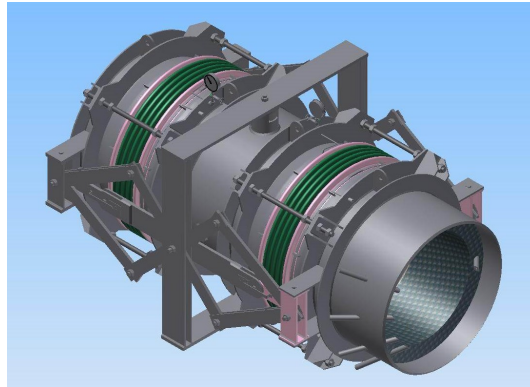

Our Product...

Flexider FCCU expansion joints are customized, engineered expansion joints. They are designed and built as per customer specifications and requirements ranging from ND 3" up to ND 100". The FCCU expansion joint bellows section features a double-ply testable solution for monitoring in the event of an inner ply failure. Each ply is designed to operate independently to avoid an external leak to the environment.

Applications...

- Fluid Catalytic Cracking

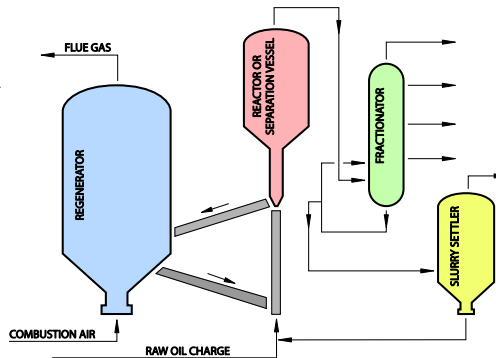

Materials...

Due to the extreme operating conditions, FCCU expansion joints are fabricated from "exotic" materials. In our ninety years of business, we have developed the expertise and experience to properly work with these materials.

- Inconels
- Incolloys
- Austenitic Steels

Design Types...

There are generally two types of expansion joints used in FCCU:

- "Cold Wall" units incorporating an abrasion resistant lining, including hex-mesh and castable material.
- Refractory and "Cold Wall" units refractory lined to ensure the shell wall temperature does not exceed the allowed parameters.

FCCU expansion joints and hardware (accessories) include:

- Gimballed
- Hinged
- Pressure Balanced
- Pantographic Linkages
- Restrained Universals

